

Douglas House, The Street, Beeston,
King's Lynn, Norfolk. PE32 2NF
Mobile: 07818 086650
Email: info@a2e-es.com



A2E Environmental Solutions Ltd
亞歐環保電機有限公司

A2E Environmental Solutions Ltd.

We are happy to discuss a solution
for your Industrial application

Filtration:

Paper Band Clarifier	Coolant Centrifuge
Magnetic Drum Filter	Hydrostatic Filter
Rotary Drum Filter	HydroCyclone Filter
Oil / Water Separators	Vacuum Filter
Filter Media	

Swarf Processing & Handling:

Steel Belting	Steel Belt Conveyors
Swarf Wringer	Swarf Shredder Swarf Briquetting Press

Vehicles:

Quad	ATV	Go-Kart	DuneBuggy
------	-----	---------	-----------

Energy Savers:

LED Bulbs	Wind Turbines	Solar Water Heating
-----------	---------------	---------------------

Consultancy Services:

Imports	Exports	Shipping/Freight
Engineering Services by Our man in China & with Your man in the UK		

Web: www.a2e-es.com

Tel: 07818 086650

A2E Environmental Solutions Ltd reserves the right to change specifications, equipment, materials, colour or any other item without notice. Please confirm full specification prior to purchase. Safety note: These machines could be hazardous if operated by unskilled workers: Always read, act & obey to the owners/maintenance manual. Always wear safety gear as necessary, ie. Helmet, boots, gloves etc when operating these machines.



A2E Environmental Solutions Ltd

Quality Imported Products, by
Our man in China & Your man in the UK



Coolant Centrifuge

Model: FC -



*Quick cleaning process ~ No media disposal
Fine Filtration ~ Easy to install
Low investment & running cost*

www.a2e-es.com

Coolant Centrifuge

Model: FC -

Design

The Centrifugal Filter consists of an outer tank with a rotating bowl & liner within. The safety control system incorporates an electronic brake and lid lock. This filter is semi-automatic and includes a clean coolant tank, bowl liner, driving system, control system and liquid pump.

Function

The Centrifugal Clarifier continuously removes solid particles from liquids under centrifugal force. The Centrifuge offers a high performance clarification, in some cases down to 5 micron. The centrifuge cannot be run when the lid is open and the lid cannot be opened, until the electronic brake is activated, stopping the bowl giving total safety.

The dirty liquid enters the top of the filter to reach the filter drum and is deflected by the centre cone towards the base of the drum. The drum is driven at a high speed so centrifugal forces act upon the dirty liquid, creating a cake of particles against the wall of the rubber liner within the bowl. The cleaned coolant overflows the bowl, through the hole in the top of the vane assembly and flows into the clean tank, ready for the clean return pump to feed the machine tool. The disposal of the semi-dry "cake" is quick and easy. The lid is opened and the liner is lifted out. The liner is emptied and cleaned within a few minutes and put back into place. The frequency of cleaning will depend on stock removal rate and type of application.

Options: Mild Steel or Stainless Steel. Add a Magnetic drum filter prior to the centrifuge which will reduce bowl emptying if heavy stock removal and allow finer filtration. Dirty Scavenge Pumping Station.

Applications

Suitable for Grinding, Parts washing, Honing, Rumbling and other machining processes on coolant lubrication, emulsions, cutting oil.

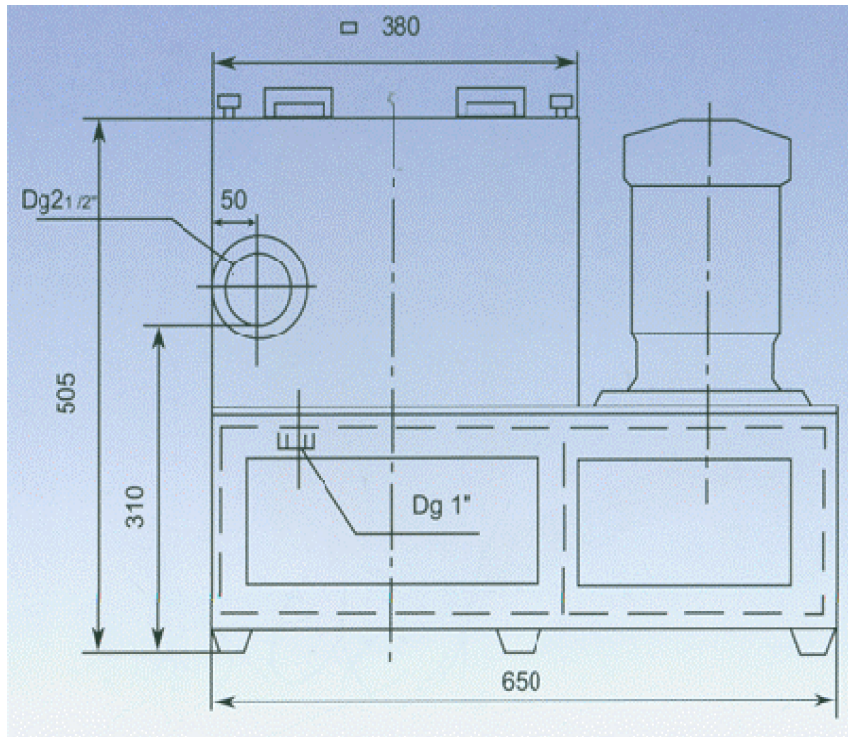

Model	Flowrate Solubles (lpm)	Flowrate Oil (lpm)	Inlet height (mm)	Width (mm)	Length (mm)	Height (mm)	Motor Watt
FCS 85	85	48	510	400	650	470	150
FCD 170	170	95	xxx	xx	xx	xx	xx

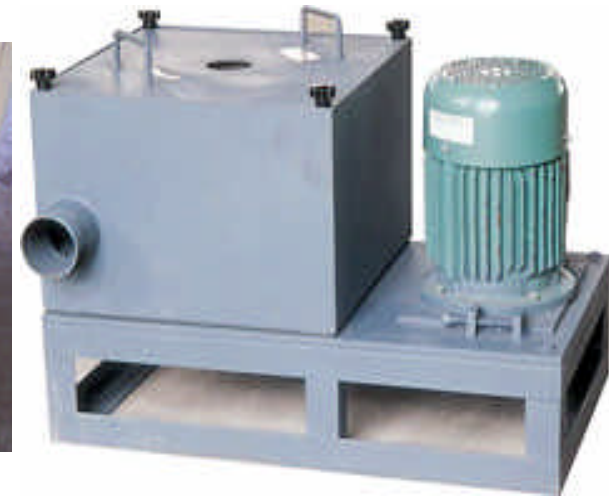

Douglas House, The Street, Beeston,
King's Lynn, Norfolk. PE32 2NF
Mobile: 07818 086650
Email: info@a2e-es.com



A2E Environmental Solutions Ltd
亞歐環保電機有限公司